

TOWN OF PARMA

1300 Hilton Parma Road
P.O. Box 728
Hilton, New York 14468
Office (585) 392-9462
Fax (585) 392-6659

TOWN BOARD MEETING
APRIL 17, 2024
5:30 P.M.

James Roose
Supervisor
Linda M Judd
Councilperson
Tina Brown
Councilperson
David Ciufu
Councilperson
Mark Acker
Councilperson

This Meeting Will Be Recorded by the Town Clerk

Pledge of Allegiance

Moment of Silence

Emergency Exit Instructions

Roll Call

PUBLIC HEARING:

1. 5:30 p.m. - Town of Parma Water Improvement Benefit Area #1

Minutes of April 2, 2024 Town Board Meeting

Town Clerk Report

Highway Superintendent Report

Parks and Recreation Director Report

Building Inspector Report

Library Report

PUBLIC FORUM:

BUSINESS ITEMS:

1. Rescind Resolution #101-2024
2. Set Public Hearing for May 22 – Spectrum Franchise Agreement
3. Approval of contract with BDP Municipal Finance
4. Rescind Resolution #70-2024
5. Approval of Snow & Ice Agreement
6. Approval to purchase a Grapple - Highway Department
7. Prepaids

INFORMATIONAL ITEMS:

LIAISON REPORTS:

WARRANT:

ADDITIONAL INFORMATION:

ADJOURNMENT:

"This institution is an equal opportunity provider, and employer. To file a complaint of discrimination, write:
USDA, Director, Office of Civil Rights, 1400 Independence Avenue, S.W., Washington, D.C. 20250-9410,
or call (800) 795-3272 (voice) or (202) 720-6382 (TDD)"



Pavillon, New York

George and Swede Sales & Service

7155 Big Tree Road

Pavillon, New York 14525

Phone 585-584-3425

800-724-8722

Fax 585-584-8853

Web www.georgeandswede.com

Scott Fisher Sales Rep.

Cell 585-297-2271

Email scottf@georgeandswede.com

Date 3/20/2024

To: Town of Parma
 Address: 31 Henery St. Hilton NY 14468
 Tel: 585-392-9464
 Cell: 585-259-0354

QUOTE EFFECTIVE FOR 10 DAYS

Quote for new ~~ROTOBEC 3042SDS Sorting & Demolition Grapple~~ \$ 35,900.00
~~Custom Lug RLP902 Rotator To Direct Fit Pin-On To The End Of Stick~~

~~This unit is quoted as per supplied spec sheet attached~~

~~This is quoted as unit delivered to you. No installation is included on this quote.~~

~~This unit is Estimated to be 8 weeks out from order date.~~

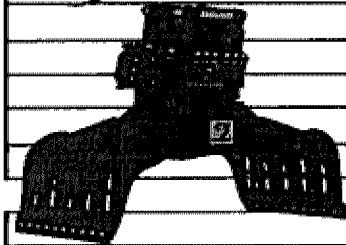

 Indeco IMG-1200S Multi Grab for Volvo EW180 W/ Demolition Sorting Jaw \$ 28,300.00

This unit is 7-10 Days out from order for your Volvo

****All specs are on the other attachment**

Quote does not include hose kit or installation

\$ -
 \$ -
 \$ -
 \$ -

Owner/Principle _____

Date _____ Title _____

Thank You Scott Fisher 585-297-2271

Interest Rates effective only till end of month-rates can potentially change each month.

New and used equipment-Sales-Rentals-Service and Parts FOB Pavillon, NY

HYUNDAI LINK BELT YANMAR INTERSTATE

All equip subject to availability Quote effective 10 days

Schedule A

Boundary Description of Proposed Town of Parma Water Improvement Benefit Area No. 1

Parcel No. 1

ALL THAT TRACT OR PARCEL OF LAND, situate in the Town of Parma, County of Monroe and State of New York, designated as Parcel No. 1 and as delineated on a map prepared by MRB Group Engineering, Architecture & Surveying, D.P.C. dated Apr 2024, entitled “District Map and Plan – Parcel No. 1” (Project No. 1637.24001) and being more particularly bounded and described as follows:

BEGINNING at a point on the centerline of Moul Road, said point being the intersection of the centerline of Moul Road and the centerline of North Avenue; thence

1. Easterly 250'±, along the centerline of Moul Road to a point being located at coordinates North 1,212,452± and East 1,357,650'± on the western boundary of the Town of Parma North Avenue Water District, said point being the Point of Beginning (POB) of the Town of Parma Water Improvement Benefit Area No. 1 - Parcel No. 1; thence
2. Northerly 250'±, along a line perpendicular to the centerline of Moul Road, to a point within Tax Map Parcel (TMP) 016.01-1-37 along the western boundary of the Town of Parma North Avenue Water District, said point being located 250'± offset perpendicular east of the centerline of North Avenue; thence
3. Westerly 4,148'± along a line parallel to and offset 250' north from the centerline of Moul Road to a point on the westerly boundary of TMP 015.02-3-46 on the northeastern corner of the Town of Parma Hamlin Parma Townline Road Water District; thence
4. Southerly 500'±, along the easterly boundary of the Town of Parma Hamlin Parma Townline Road Water District to a point within TMP 015.04-2-2, said point being located on the southeastern corner of the Town of Parma Hamlin Parma Townline Road Water District; thence
5. Easterly 4,146'±, along a line parallel to and 250' offset south of to the centerline of Moul Road, to a point within TMP 016.03-1-6, said point being located on the western boundary of the Town of Parma North Avenue Water District and 250'± offset perpendicular west of the centerline of North Avenue; thence
6. Northerly 250'±, along a line perpendicular to the centerline of Moul Road along the westerly boundary of Town of Parma North Avenue Water District, said location being the point and place of beginning of Parcel No. 1.

Parcel No. 2

ALL THAT TRACT OR PARCEL OF LAND, situate in the Town of Parma, County of Monroe and State of New York, designated as Parcel No. 2 and as delineated on a map prepared by MRB Group Engineering, Architecture & Surveying, D.P.C. dated Apr 2024, entitled “District Map and Plan – Parcel No. 2” (Project No. 1637.24001) and being more particularly bounded and described as follows:

BEGINNING at a point on the centerline of Moul Road, said point being the intersection of the centerline of Moul Road and the centerline of North Avenue; thence

1. Westerly 250'±, along the centerline of Moul Road to a point being located at coordinates North 1,212,491± and East 1,358,148± on the eastern boundary of the Town of Parma North Avenue Water District, said point being the Point of Beginning (POB) of the Town of Parma Water Improvement Benefit Area No. 1 - Parcel No. 2; thence
2. Northerly 250'±, along a line perpendicular to the centerline of Moul Road along the eastern boundary of the Town of Parma North Avenue Water District to a point within TMP 016.01-2-26.115, said point being located 250'± offset perpendicular east of the centerline of North Avenue; thence
3. Easterly 5,034'±, along a line parallel to and offset 250' north from the centerline of Moul Road to a point on the centerline of Bennett Road, said point being located on the northwest corner of the Town of Parma Lighthouse Road Water District on the centerline of Bennett Road, 250'± offset perpendicular north of the intersection of the centerlines of Bennett Road and Moul Road; thence
4. Southerly 500'±, along the easterly boundary of the Town of Parma Lighthouse Road Water District, said boundary line being coincident with the centerline Bennett Road to a point being located offset 250'± perpendicular south from the centerline of Moul Road, said point being the southeast corner of the Town of Parma Lighthouse Road Water District; thence
5. Westerly 5,034'±, along a line parallel to and 250' offset south of to the centerline of Moul Road, to a point within TMP 016.03-2-6 on the eastern boundary of the Town of Parma North Avenue Water District, said point being located 250'± offset perpendicular east of the centerline of North Avenue; thence
6. Northerly 250'±, along a line perpendicular to the centerline of Moul Road along the westerly boundary of the Town of Parma North Avenue Water District, said location being the point and place of beginning of Parcel No. 2.

Parcel No. 3

ALL THAT TRACT OR PARCEL OF LAND, situate in the Town of Parma, County of Monroe and State of New York, designated as Parcel No. 3 and as delineated on a map prepared by MRB Group Engineering, Architecture & Surveying, D.P.C. dated Apr 2024, entitled “District Map and Plan – Parcel No. 3” (Project No. 1637.24001) and being more particularly bounded and described as follows:

BEGINNING at a point on the centerline of Curtis Road, said point being the intersection of the centerline of Curtis Road and the centerline of North Avenue; thence

1. Easterly 250'±, along the centerline of Moul Road to a point being located at coordinates North 1,207,174± and East 1,358,038± on the western boundary of the Town of Parma North Avenue Water District, said point being the Point of Beginning (POB) of the Town of Parma Water Improvement Benefit Area No. 1 - Parcel No. 3; thence
2. Northerly 250'±, along a line perpendicular to the centerline of Curtis Road along the western boundary of the Town of Parma North Avenue Water District, to a point within TMP 016.03-1-50, said point being located 250'± offset perpendicular east of the centerline of North Avenue; thence
3. Westerly 6,053'± along a line parallel to and offset 250' north from the centerline of Curtis Road to a point within TMP 015.04-2-12.11 on the existing northeastern corner of the Town of Parma Hamlin Parma Townline Road Water District; thence
4. Southerly 500'±, along the easterly boundary of the Town of Parma Hamlin Parma Townline Road Water District to the southeastern corner of the Town of Parma Hamlin Parma Townline Road Water District coincident with a point on the western boundary of TMP 023.02-1-6, said point being located offset 250'± perpendicular south from the centerline of Curtis Road; thence
5. Easterly 883'±, along a line parallel to and 250' offset south of to the centerline of Curtis Road, to a point within TMP 023.02-1-13.111, said point being located 250'± offset perpendicular west of the centerline of Collamer Avenue; thence
6. Southerly 85'±, along a line parallel to and 250' offset west of to the centerline of Collamer Avenue, to a point within TMP 023.02-1-13.111; thence
7. Easterly 500'±, along a line perpendicular to the centerline of Collamer Avenue, to a point within TMP 023.02-2-2.003, said point being located 250'± offset perpendicular east of the centerline of Collamer Avenue; thence
8. Northerly 84'±, along a line parallel to and 250' offset east of to the centerline of Collamer Avenue, to a point within 023.02-2-2.003; thence

9. Easterly 4,669'±, along a line parallel to and 250' offset south of to the centerline of Curtis Road, to a point within TMP 024.01-1-2.1, said point being located on the westerly boundary of the Town of Parma North Avenue Water District and 250'± offset perpendicular west of the centerline of North Avenue; thence
10. Northerly 250'±, along a line perpendicular to the centerline of Curtis Road along the westerly boundary of Town of Parma North Avenue Water District, said location being the point and place of beginning of Parcel No. 3.

Parcel No. 4

ALL THAT TRACT OR PARCEL OF LAND, situate in the Town of Parma, County of Monroe and State of New York, designated as Parcel No. 4 and as delineated on a map prepared by MRB Group Engineering, Architecture & Surveying, D.P.C. dated Apr 2024, entitled “District Map and Plan – Parcel No. 4” (Project No. 1637.24001) and being more particularly bounded and described as follows:

BEGINNING at a point on the centerline of Curtis Road, said point being the intersection of the centerline of Curtis Road and the centerline of North Avenue; thence

1. Easterly 250'±, along the centerline of Curtis Road to a point being located at coordinates North 1,207,202± and East 1,358,537± on the western boundary of The Town of Parma North Avenue Water District, said point being the Point of Beginning (POB) of the Town of Parma Water Improvement Benefit Area No. 1 - Parcel No. 4; thence
2. Northerly 250'±, along a line perpendicular to the centerline of Curtis Road and along the eastern boundary of the Town of Parma North Avenue Water District, to a point within TMP 016.03-2-27, said point being located 250'± offset perpendicular east of the centerline of North Avenue; thence
3. Easterly 4,732'±, along a line parallel to and offset 250' north from the centerline of Curtis Road to a point within TMP 016.03-2-21, said point being located on the western boundary of the Town of Parma Lighthouse Road Water District, 250'± offset perpendicular west of the centerline of Bennet Road; thence
4. Southerly 500'±, along the easterly boundary of the Town of Parma Lighthouse Road Water District to a point within TMP 024.01-2-1.1, said point being located offset 250'± perpendicular west from the centerline of Bennett Road; thence
5. Westerly 4,721'±, along a line parallel to and 250' offset south of to the centerline of Curtis Road, to a point within TMP 024.01-2-14.2 on the western boundary of the Town of Parma North Avenue Water District, said point being located 250'± offset perpendicular east of the centerline of North Avenue; thence
6. Northerly 250'±, along a line perpendicular to the centerline of Moul Road along the western boundary of Town of Parma North Avenue Water District, said location being the point and place of beginning of Parcel No. 4.

Parcel No. 5

ALL THAT TRACT OR PARCEL OF LAND, situate in the Town of Parma, County of Monroe and State of New York, designated as Parcel No. 5 and as delineated on a map prepared by MRB Group Engineering, Architecture & Surveying, D.P.C. dated Apr 2024, entitled “District Map and Plan – Parcel No. 5” (Project No. 1637.24001) and being more particularly bounded and described as follows:

BEGINNING at a point on the centerline of Moul Road, said point being the intersection of the centerline of Moul Road and the centerline of Bennett Road; thence

1. Northerly 250'±, along the centerline of Bennett Road coincident with the western boundary of the Town of Parma Lighthouse Road Water District to a point being located at coordinates North 1,213,163'± and East 1,363,148'± on the northwest corner of the Town of Parma Lighthouse Road Water District, said point being the Point of Beginning (POB) of the Town of Parma Water Improvement Benefit Area No. 1 - Parcel No. 5; thence
2. Westerly 250'±, along a line perpendicular to the centerline of Bennett Road, to a point within TMP 016.01-2-18.13, said point being located 250'± offset perpendicular north of the centerline of Moul Road; thence
3. Northerly 2,099'±, along a line parallel to and offset 250' west from the centerline of Bennett Road to a point within TMP 016.01-2-15, said point being located on the southern boundary of the Town of Parma Huffer Road Water District, 250'± offset perpendicular south of the centerline of Huffer Road; thence
4. Easterly 500'±, along the southern boundary of the Town of Parma Huffer Road Water District to a point within TMP 016.02-1-43.212, said point being located offset 250'± perpendicular east from the centerline of Bennett Road; thence
5. Southerly 2,106'±, along a line parallel to and 250' offset east of to the centerline of Bennett Road, to a point within TMP 016.02-1-43.1 on the northern boundary of the Town of Parma Lighthouse Road Water District, said point being located 250'± offset perpendicular north of the centerline of Moul Road; thence
6. Westerly 250'±, along a line perpendicular to the centerline of Bennett Road along the northern boundary of Town of Parma Lighthouse Road Water District, said location being the point and place of beginning of Parcel No. 5.

Parcel No. 6

ALL THAT TRACT OR PARCEL OF LAND, situate in the Town of Parma, County of Monroe and State of New York, designated as Parcel No. 6 and as delineated on a map prepared by MRB Group Engineering, Architecture & Surveying, D.P.C. dated Apr 2024, entitled “District Map and Plan – Parcel No. 6” (Project No. 1637.24001) and being more particularly bounded and described as follows:

BEGINNING at a point on the centerline of Moul Road, said point being the intersection of the centerline of Moul Road and the centerline of Bennett Road; thence

1. Southerly 250'±, along the centerline of Bennett Road coincident with the western boundary of the Town of Parma Lighthouse Road Water District to a point being located at coordinates North 1,212,664'± and East 1,363,181'± on the southwestern corner of the Town of Parma Lighthouse Road Water District, said point being the Point of Beginning (POB) of the Town of Parma Water Improvement Benefit Area No. 1 - Parcel No. 6; thence
2. Westerly 250'±, along a line perpendicular to the centerline of Bennett Road, to a point within TMP 016.01-2-38, said point being located 250'± offset perpendicular south of the centerline of Moul Road; thence
3. Southerly 4,027'±, along a line parallel to and offset 250' west from the centerline of Bennett Road to a point on the northern boundary of TMP 016.03-2-11.2, said point being located on the northwest corner of the Town of Parma Lighthouse Road Water District; thence
4. Easterly 500'±, along the northern boundary of the Town of Parma Lighthouse Road Water District to a point within TMP 016.04-1-18.31, said point being the northeast corner of the Town of Parma Lighthouse Road Water District; thence
5. Northerly 4,044'±, along a line parallel to and 250' offset east of to the centerline of Bennett Road, to a point within TMP 016.02-1-52 on the southern boundary of the Town of Parma Lighthouse Road Water District, said point being located 250'± offset perpendicular south of the centerline of Moul Road; thence
6. Westerly 250'±, along a line perpendicular to the centerline of Bennett Road along the southern boundary of Town of Parma Lighthouse Road Water District, said location being the point and place of beginning of Parcel No. 6.



Parcel No. 7

ALL THAT TRACT OR PARCEL OF LAND, situate in the Town of Parma, County of Monroe and State of New York, designated as Parcel No. 7 and as delineated on a map prepared by MRB Group Engineering, Architecture & Surveying, D.P.C. dated Apr 2024, entitled “District Map and Plan – Parcel No. 7” (Project No. 1637.24001) and being more particularly bounded and described as follows:

BEGINNING at a point on the centerline of Curtis Road, said point being the intersection of the centerline of Curtis Road and the centerline of Bennett Road; thence

1. Southerly 250'±, along the centerline of Bennett Road to a point being located at coordinates North 1,207,259'± and East 1,363,516'± on the southern boundary of the Town of Parma Lighthouse Road Water District, said point being the Point of Beginning (POB) of the Town of Parma Water Improvement Benefit Area No. 1 - Parcel No. 7; thence
2. Westerly 250'±, along a line perpendicular to the centerline of Bennett Road, to a point within TMP 024.01-2-1.1 on the southwestern corner of the Town of Parma Lighthouse Road Water District, said point being located 250'± offset perpendicular south of the centerline of Curtis Road; thence
3. Southerly 589'±, along a line parallel to and offset 250' west from the centerline of Bennett Road to a point within TMP 024.01-2-1.1; thence
4. Easterly 500'±, along a line perpendicular to the centerline of Bennett Road to a point within TMP 024.02-1-26.1; thence
5. Northerly 589'±, along a line parallel to and 250' offset east of to the centerline of Bennett Road, to a point within TMP 024.02-1-1.2 on the southern boundary of the Town of Parma Lighthouse Road Water District, said point being located 250'± offset perpendicular south of the centerline of Curtis Road; thence
6. Westerly 250'±, along a line perpendicular to the centerline of Bennett Road along the southern boundary of Town of Parma Lighthouse Road Water District, said location being the point and place of beginning of Parcel No. 7.

HEREBY INTENDING TO DESCRIBE IN ITS ENTIRETY, those seven (7) Parcels of land situated in the Town of Parma, Monroe County, New York to be collectively known and identified as the Town of Parma Water Improvement Benefit Area No. 1.

 Water Improvement Benefit Area No. 1
 Existing Water District



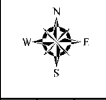

WATER IMPROVEMENT BENEFIT AREA NO. 1
 TOWN OF PARMA, MONROE COUNTY, NEW YORK
 DISTRICT MAP AND PLAN - OVERVIEW



Drawn By: T.J.V.
 Scale: 1" = 100'
 Date: APR 2024

MRB | group
 Landscape Architecture & Surveying, LLC
 149 Calver Road, Suite 100, Rochester, New York 14620 | 585-381-0200 | www.mrbgroup.com

SHEET NO.
 1 of 8
 PROJECT NO.
 1637-24001

 Water Improvement Benefit Area No. 1 - Parcel No. 1
 Existing Water District

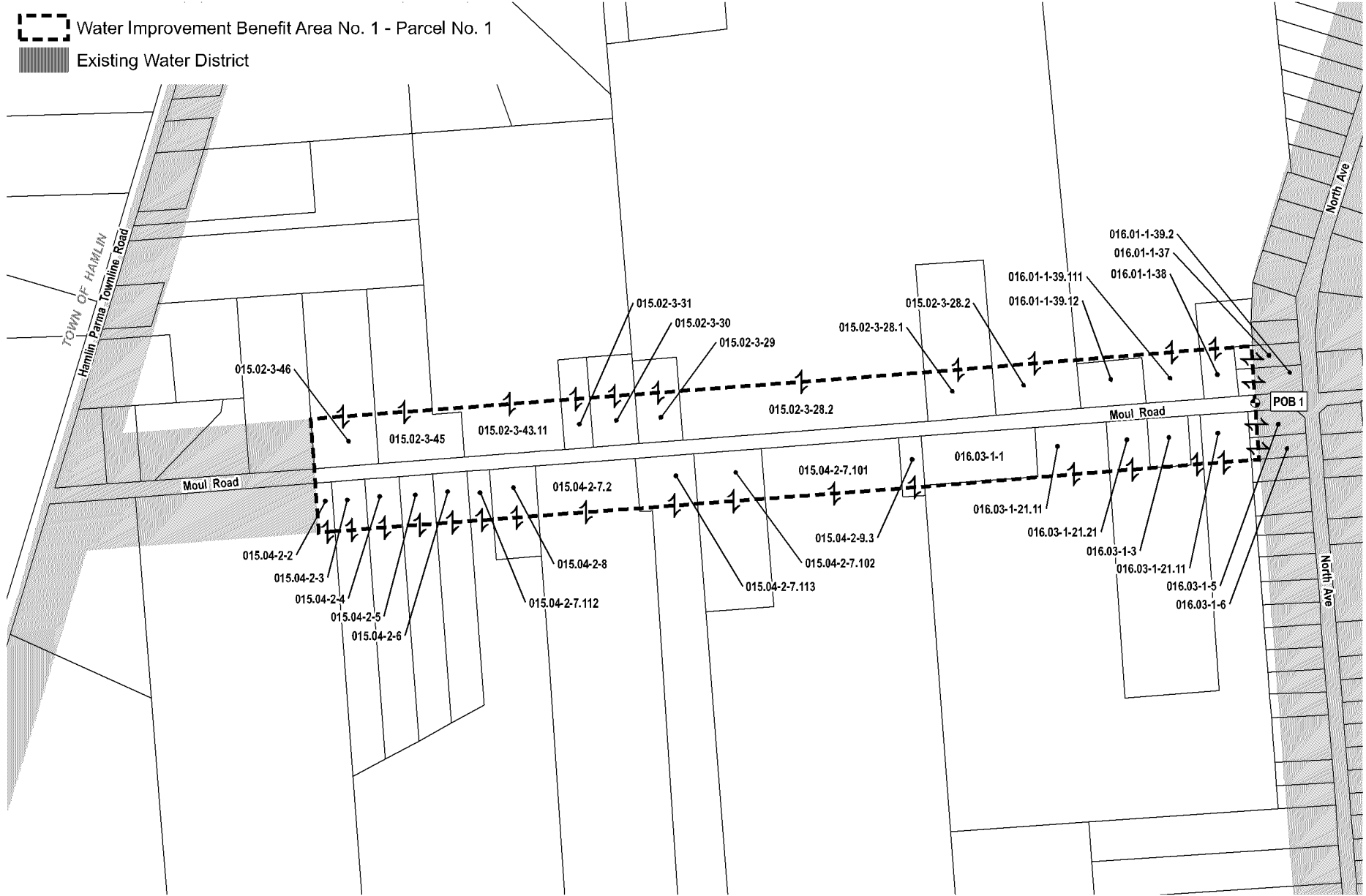



WATER IMPROVEMENT BENEFIT AREA NO. 1
 TOWN OF PARMA, MONROE COUNTY, NEW YORK
 DISTRICT MAP AND PLAN - PARCEL NO. 1



Drawn By: TJV
 Scale: 1" = 100'
 @ 11" x 17"
 Date: APR 2024

MRB | group
 Landscape Architects & Surveyors, LLC
 149 Calvert Road, Suite 100, Arcadia, New York 14201 785-381-0700
 www.mrbgroup.com

SHEET NO.
 2 of 8
 PROJECT NO.
 1637.24001

 Water Improvement Benefit Area No. 1 - Parcel No. 2
 Existing Water District

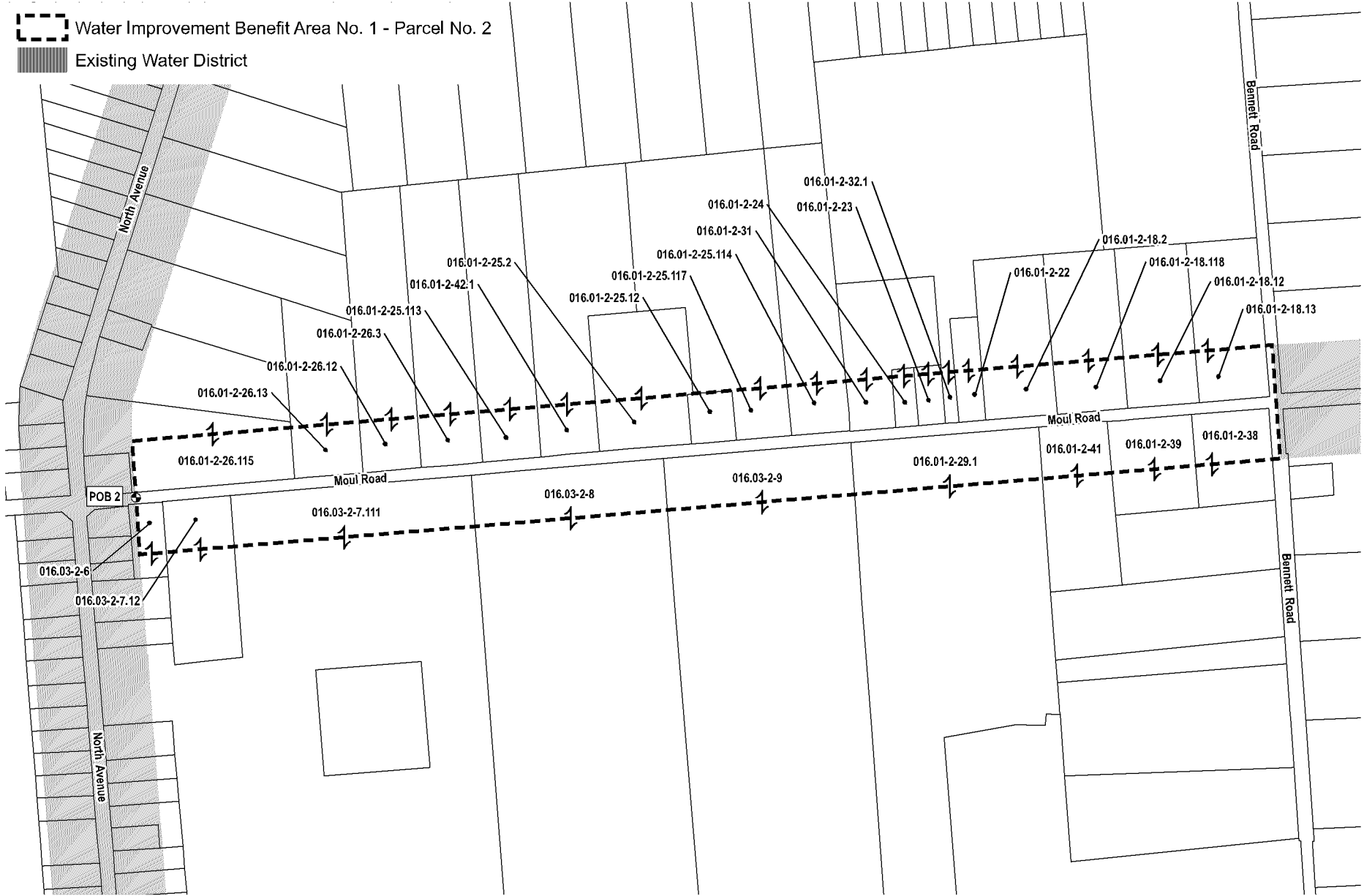

WATER IMPROVEMENT BENEFIT AREA NO. 1
 TOWN OF PARMA, MONROE COUNTY, NEW YORK
 DISTRICT MAP AND PLAN - PARCEL NO. 2





T J V
 1" = 100'
 @ 11" x 17"
 APR 2024

Drawn By:
 Scale:
 Date:

MRB | group
 Landscape Architects & Surveyors, LLC
 145 Calverton Blvd., Suite 100, Amherst, New York 14226 | 781-581-0200 | www.mrbgroup.com

SHEET NO.
 3 of 8
 PROJECT NO.
 1637-24001

 Water Improvement Benefit Area No. 1 - Parcel No. 3
 Existing Water District

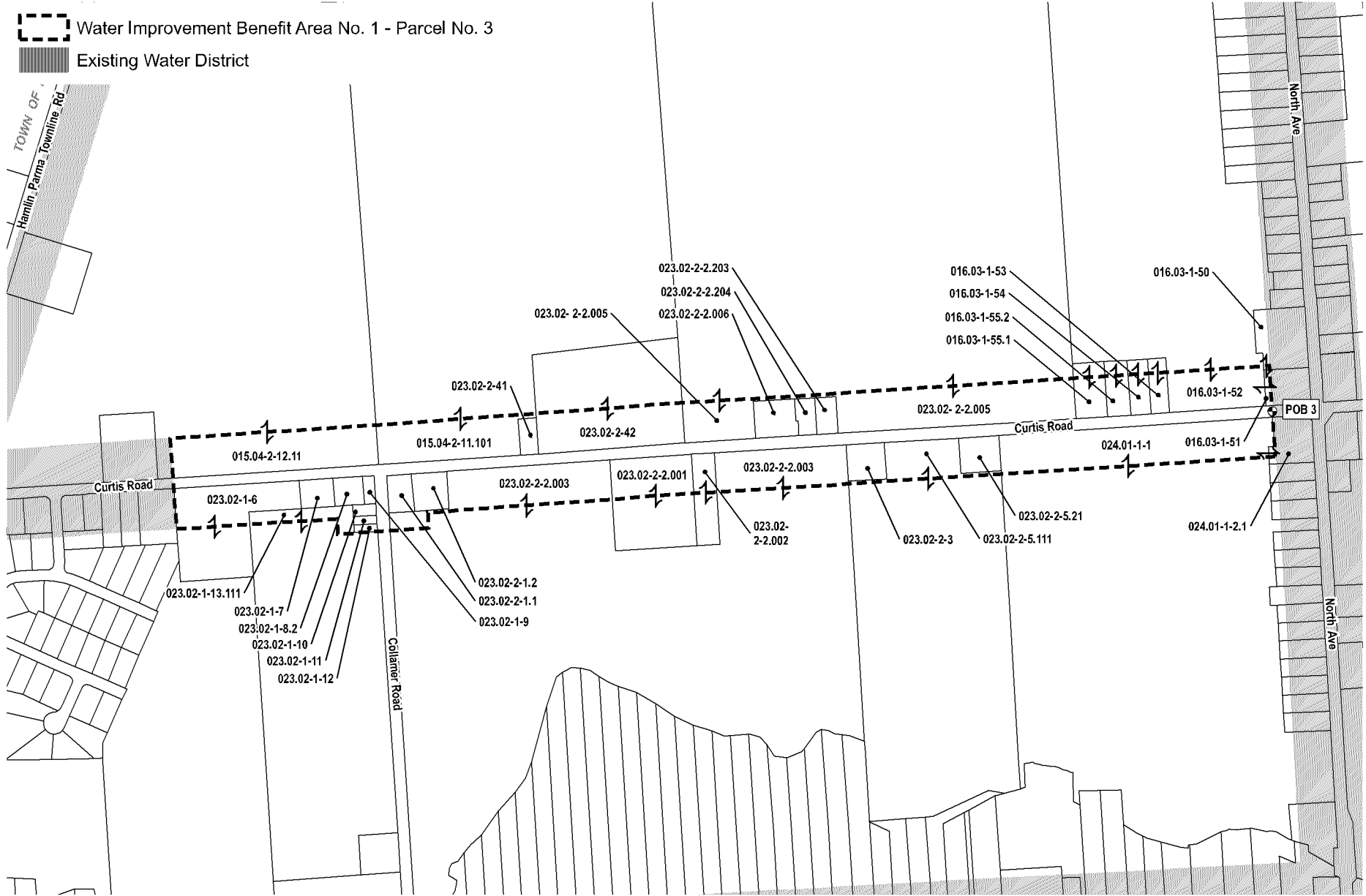



WATER IMPROVEMENT BENEFIT AREA NO. 1
 TOWN OF PARMA, MONROE COUNTY, NEW YORK
 DISTRICT MAP AND PLAN - PARCEL NO. 3



Drawn By: TJV
 Scale: 1" = 50'
 @ 11" x 17"
 Date: APR 2024

MRB | group
 Landscape Architects & Surveyors, LLC
 149 Calver Road, Suite 100, Rochester, New York 14220 | 585-381-0200 | www.mrbgroup.com

SHEET NO.
 4 of 8
 PROJECT NO.
 1637.24001

 Water Improvement Benefit Area No. 1 - Parcel No. 4
 Existing Water District

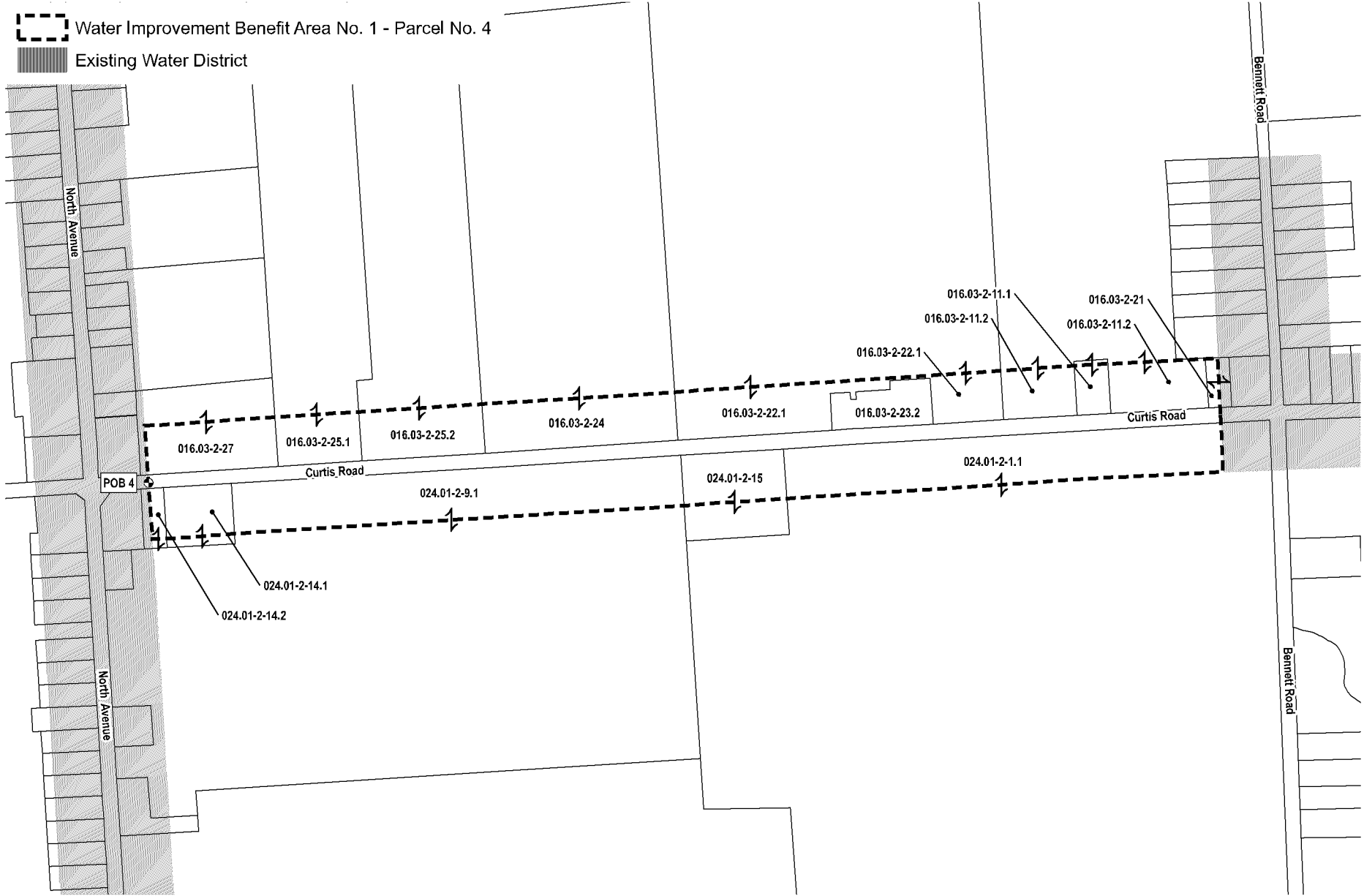



WATER IMPROVEMENT BENEFIT AREA NO. 1
 TOWN OF PARMA, MONROE COUNTY, NEW YORK
 DISTRICT MAP AND PLAN - PARCEL NO. 4



Drawn By: TJV
 Scale: 1" = 100'
 @ 11" x 17"
 Date: APR 2024

MRB | group
 Landscaping, Architecture, & Surveying, LLC
 149 Calver Road, Suite 100, Arcadia, New York 14221 | 781-581-0220 | www.mrbgroup.com

SHEET NO.
 5 of 8
 PROJECT NO.
 1637.24001

 Water Improvement Benefit Area No. 1 - Parcel No. 5
 Existing Water District

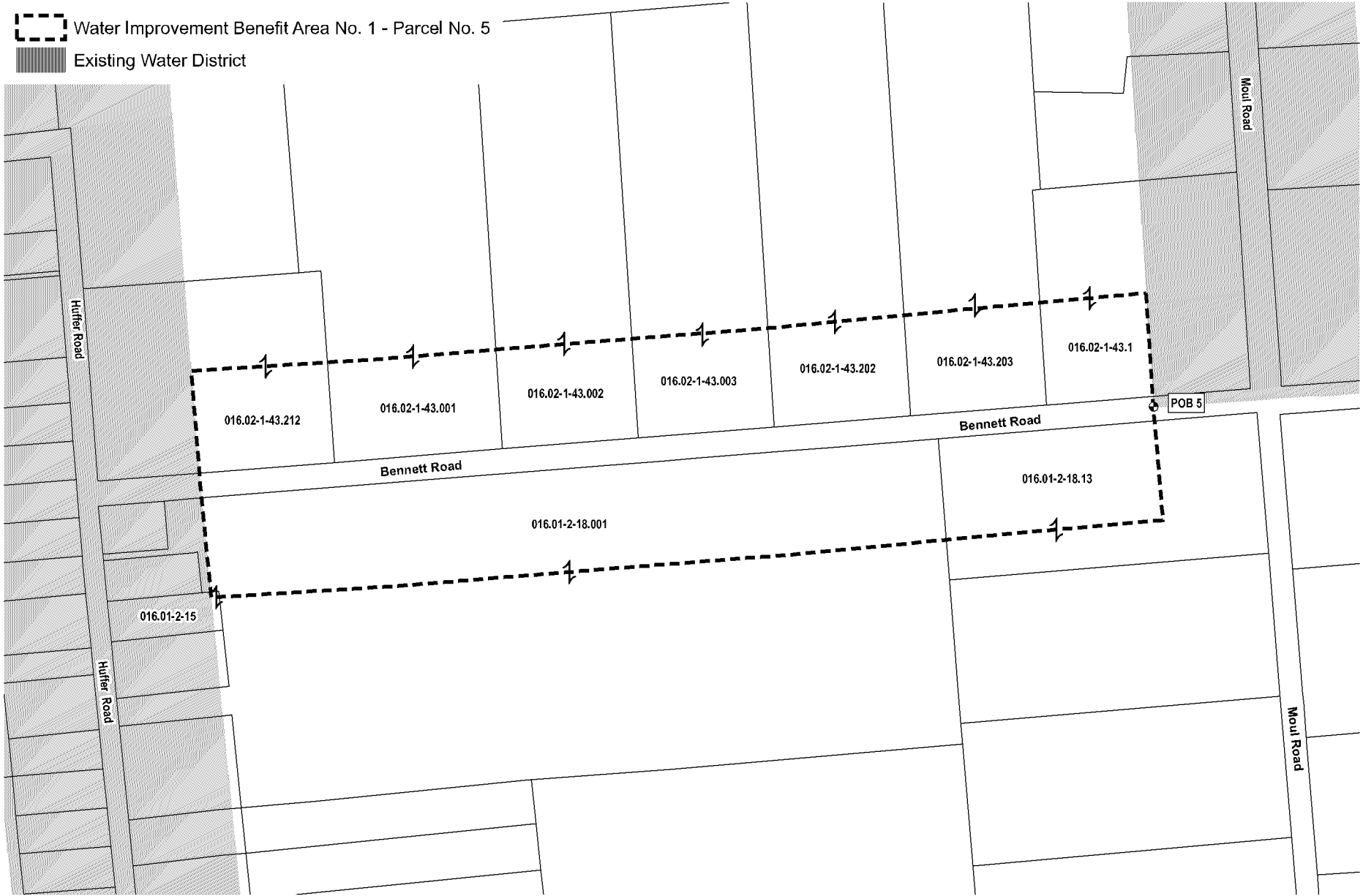

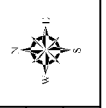

WATER IMPROVEMENT BENEFIT AREA NO. 1
 TOWN OF PARMA, MONROE COUNTY, NEW YORK
 DISTRICT MAP AND PLAN - PARCEL NO. 5



Drawn By:	TJV
Scale:	1" = 200' @ 11" x 17"
Date:	APR 2024

MRB | group
 Landscaping, Architecture, & Surveying, LLC
 149 Cullen Road, Suite 100, Arcadia, New York 14221 | 781-581-0720 | www.mrbgroup.com

SHEET NO.
 6 of 8
 PROJECT NO.
 1637.24001

 Water Improvement Benefit Area No. 1 - Parcel No. 6
 Existing Water District

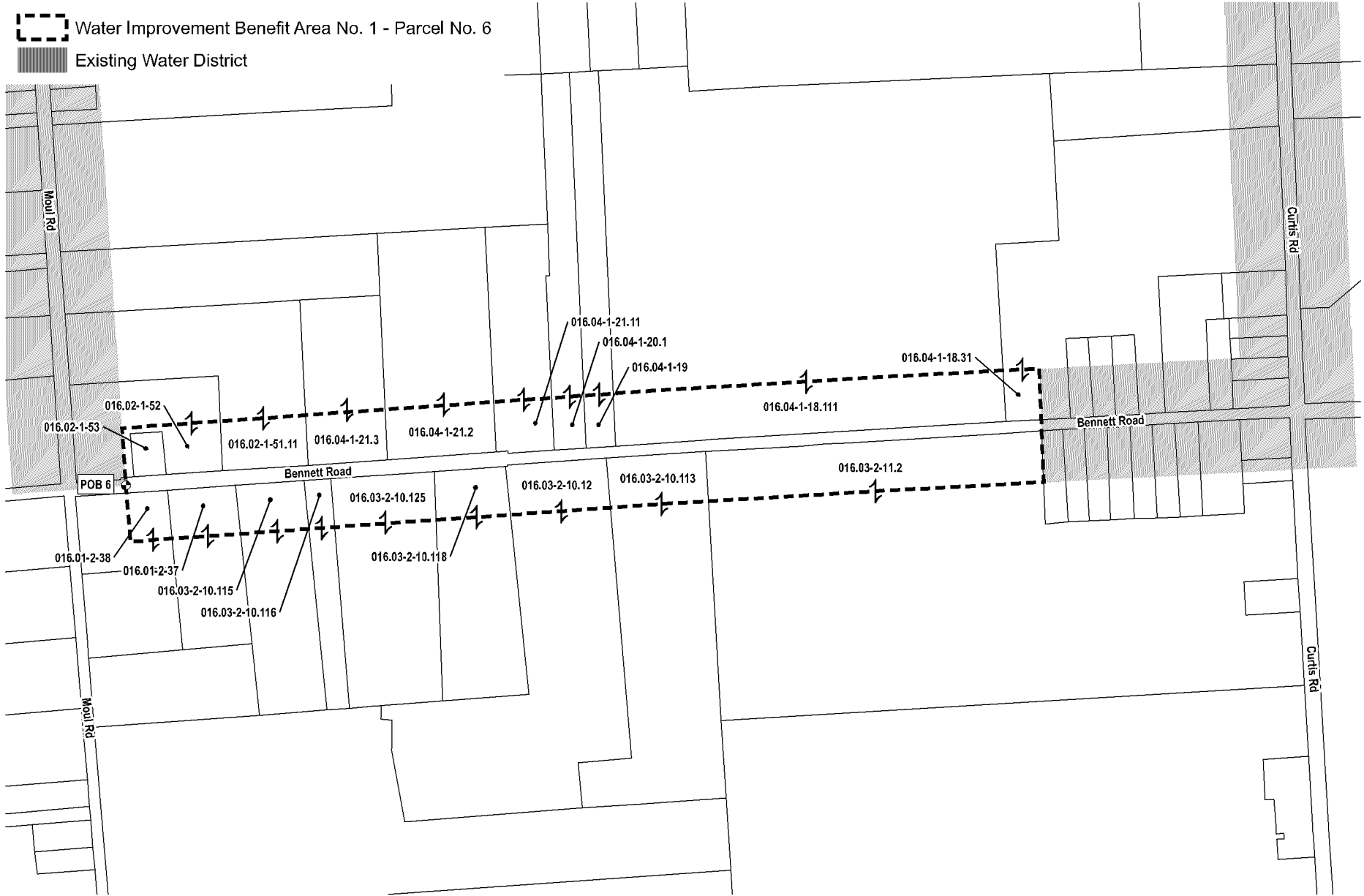



WATER IMPROVEMENT BENEFIT AREA NO. 1
 TOWN OF PARMA, MONROE COUNTY, NEW YORK
 DISTRICT MAP AND PLAN - PARCEL NO. 6



Drawn By: T.J.V.
 Scale: 1" = 100'
 @ 11" x 17"
 Date: APR 2024

MRB | group
 Landscaping, Architecture, & Surveying, LLC
 145 Cullen Road, Suite 100, Arcadia, New York 14221 | 781-581-0720 | 11r.me
 www.mrbgroup.com

SHEET NO.
 7 of 8
 PROJECT NO.
 1637.24001

 Water Improvement Benefit Area No. 1 - Parcel No. 7
 Existing Water District



WATER IMPROVEMENT BENEFIT AREA NO. 1
 TOWN OF PARMA, MONROE COUNTY, NEW YORK
 DISTRICT MAP AND PLAN - PARCEL NO. 7



Drawn By:	TJV
Scale:	1" = 200' @ 11" x 17"
Date:	APR 2024

MRB | group
 Landscape Architects & Surveyors, LLC
 145 Cullen Road, Suite 100, Rochester, New York 14220 | 585-581-0220 | r.m.r
 www.mrbgroup.com

SHEET NO.
 8 of 8
 PROJECT NO.
 1637.24001