

**CITY OF RICE LAKE
COMMON COUNCIL
BARRON COUNTY, WISCONSIN**

ORDINANCE NO. 24-06

**AN ORDINANCE TO AMEND ORDINANCE NO. 23-17 AND ATTACH AND DETACH
REAL ESTATE FROM THE CITY OF RICE LAKE, BARRON COUNTY, WISCONSIN,
PURSUANT TO THE INTERGOVERNMENTAL BOUNDARY AGREEMENT WITH
THE TOWN OF RICE LAKE, BARRON COUNTY, WISCONSIN**

The Common Council of the City of Rice Lake, Wisconsin, hereby ordains Ordinance No. 23-17 amended to read as follows:

1. In accordance with the Intergovernmental Boundary Agreement between the City of Rice Lake (“City”) and Town of Rice Lake (“Town”), approved by both the City and Town on August 31, 2023 (the “Agreement”), the real estate described in the attached and incorporated Exhibit A shall be attached to the City (the “Attached Parcels”) and the real estate described in the attached and incorporated Exhibit B shall be detached from the City and become a part of the Town (the “Detached Parcels”). The Attached Parcels and Detached Parcels shall be as shown on the attached and incorporated Exhibit C.
2. From and after the date of adoption and publication of this Ordinance and filing of this Ordinance with the Wisconsin Department of Administration, the Attached Parcels shall be a part of the City of Rice Lake for any and all purposes provided by law and all persons coming within such territory shall be subject to all ordinances, rules, and regulations governing the City.
3. From and after the date of adoption and publication of this Ordinance and filing of this Ordinance with the Wisconsin Department of Administration, the Detached Parcels shall be a part of the Town of Rice Lake for any and all purposes provided by law and all persons coming within such territory shall be subject to all ordinances, rules, and regulations governing the Town.
4. The Attached Parcels shall be made a part of the City wards and Barron County Supervisory Districts set forth on the attached Exhibit A.
5. The population of the Attached Parcels is 0.
6. The population of the Detached Parcels is 0.
7. The City’s official map shall be changed to reflect the changes set forth in this Ordinance. Except as amended, the City’s official map is hereby reaffirmed in its entirety.
8. If any provisions of this Ordinance or any application of this Ordinance to any person or circumstance is found to be invalid or unconstitutional, such a finding shall not affect the

other provisions or applications of this Ordinance which can be given effect without the invalid or unconstitutional provision or applications.

9. This Ordinance shall be effective upon passage and publication as required by law.

Adopted by the Common Council on March 26,, 2024.

CITY OF RICE LAKE

By: 
Justin Fonfara, Mayor

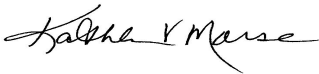
Attest: 
Kathleen V. Morse, City Clerk-Treasurer

Published: April 10, 2024

EXHIBIT A
ATTACHED PARCELS

To the extent any of the following parcels or parts thereof are currently part of the Town of Rice Lake, these parcels shall be attached to the City of Rice Lake:

1. Being all of Lot 46 Assessor's Plat No. 2 of Lots 61-125 of the Plat of Hiawatha Park (now vacated), located in the Southeast $\frac{1}{4}$ of the Northeast $\frac{1}{4}$, of Section 16, Township 35 North, Range 11 West, City of Rice Lake, Barron County, Wisconsin.

Parcel Numbers: 038-4001-12-000 & 276-1111-34-000

Approximately 0.54 acres.

2. Being all of Lot 10 Assessor's Plat No. 2 of Lots 61-125 of the Plat of Hiawatha Park (now vacated), located in the Northeast $\frac{1}{4}$ of the Northeast $\frac{1}{4}$, of Section 16, Township 35 North, Range 11 West, City of Rice Lake, Barron County, Wisconsin.

Parcel Numbers: 038-4001-11-000 & 276-1111-03-000

Approximately 0.314 acres.

Parcel 038-4001-12-000 shall be a part of Ward 21 and County Supervisory District 25.

Parcel 038-4001-11-000 shall be a part of Ward 22 and County Supervisory District 25.

Ward 21 and 22 have been created contemporaneous with this Ordinance via Ordinance No. 24-07 and Ordinance No. 24-08, respectively.

**EXHIBIT B
DETACHED PARCELS**

To the extent any of the following parcels or parts thereof are currently part of the City of Rice Lake, these parcels shall be detached from the City of Rice Lake and become a part of the Town of Rice Lake:

1. Being all of Lot 3, Shudlick Park, located in the Northeast $\frac{1}{4}$ of the Southeast $\frac{1}{4}$ of Section 16, Township 35 North, Range 11 West, Town of Rice Lake, Barron County, Wisconsin.

Parcel Number: 038-4419-05-000

Approximately 0.41 acres.

2. Being all of Lot 4, Shudlick Park, located in the Northeast $\frac{1}{4}$ of the Southeast $\frac{1}{4}$ of Section 16, Township 35 North, Range 11 West, Town of Rice Lake, Barron County, Wisconsin.

Parcel Number: 038-4419-06-000

Approximately 0.45 acres.

3. Being a part of the Southwest $\frac{1}{4}$ of the Southwest $\frac{1}{4}$ of Section 15, Township 35 North, Range 11 West, Town of Rice Lake, Barron County, Wisconsin, more particularly described as follows:

Commencing at the South $\frac{1}{4}$ Corner of said Section 15; thence westerly to the southeast corner of the Southwest $\frac{1}{4}$ of the Southwest $\frac{1}{4}$ of said Section 15 also being the point of beginning; thence continuing westerly to the southeast corner of Lot 1, Certified Survey Map No. 6792, Volume 45, Page 31, as Document No. 878287; thence northerly to the northeast corner of said Lot 1; thence westerly along the northerly line of said Lot 1 to the ordinary highwater mark of Rice Lake; thence northerly and westerly along the ordinary highwater mark of Rice Lake to its intersection with the westerly boundary of the Southwest $\frac{1}{4}$ of the Southwest $\frac{1}{4}$ of said Section 15; thence northerly to the northwest corner of the Southwest $\frac{1}{4}$ of the Southwest $\frac{1}{4}$ of said Section 15; thence easterly to the northeast corner of the Southwest $\frac{1}{4}$ of the Southwest $\frac{1}{4}$ of said Section 15; thence southerly to the point of beginning.

Parcel Number: 038-1500-26-000

Approximately 31.83 acres.

4. Being all of Lot 3, Clearwater Bay Park, located in the Northeast ¼ of the Northeast ¼ of Section 27, Township 35 North, Range 11 West, Town of Rice Lake, Barron County, Wisconsin.

Parcel Number: 038-4045-04-000

Approximately 0.5 acres.

5. Being all of Lot 2, Clearwater Bay Park, located in the Northeast ¼ of the Northeast ¼ of Section 27, Township 35 North, Range 11 West, Town of Rice Lake, Barron County, Wisconsin.

Parcel Number: 038-4045-03-000

Approximately 0.51 acres.

6. Being all of Lot 1, Clearwater Bay Park, located in the Northeast ¼ of the Northeast ¼ of Section 27, Township 35 North, Range 11 West, Town of Rice Lake, Barron County, Wisconsin.

Parcel Number: 038-4045-02-000

Approximately 0.53 acres.

7. Being part of Lots 19 and 20, Rice Lake Summer Resort, located in the Southeast ¼ of the Northeast ¼ of Section 27, Township 35 North, Range 11 West, Town of Rice Lake, Barron County, Wisconsin, more particularly described as follows:

Commencing at the intersection of the north line of said Lot 20 with the westerly right of way of 21 7/8th Street also being the point of beginning; thence southerly along the said westerly right of way to its intersection with the southerly line of said Lot 19; thence westerly along the southerly line of said Lot 19 to the ordinary high water mark of Rice Lake; thence northerly along the ordinary high water mark of Rice Lake to the northerly line of said Lot 20; Thence easterly along the said northerly line to the point of beginning.

Parcel Number: 038-4375-23-000

Approximately 0.66 acres.

8. Being all of Lot 8, Rice Lake Summer Resort, located in the Southeast ¼ of the Northeast ¼ of Section 27, Township 35 North, Range 11 West, Town of Rice Lake, Barron County, Wisconsin.

Parcel Number: 038-4375-11-000

Approximately 0.29 acres.

9. Being a part of Lots 6 and 7, Rice Lake Summer Resort, located in the Southeast $\frac{1}{4}$ of the Northeast $\frac{1}{4}$, Section 27, Township 35 North, Range 11 West, Town of Rice Lake, Barron County, Wisconsin, more particularly described as follows:

Commencing at the northeast corner of said Lot 7; thence southerly along the easterly line of said Lots 6 and 7 a distance of 98.53 feet more or less to a point at the intersection of said easterly line and the line dividing the north half and south half of Lot 6; thence westerly along the said line dividing the north half and south half of Lot 6 to the ordinary high water mark on the east side of Rice Lake; thence northerly along the said ordinary high water mark to its intersection with the north line of said Lot 7; thence easterly to the point of beginning.

Parcel Number: 038-4375-10-000

Approximately 0.38 acres.

10. Being a part of Lots 5 and 6, Rice Lake Summer Resort, located in the Southeast $\frac{1}{4}$ of the Northeast $\frac{1}{4}$, Section 27, Township 35 North, Range 11 West, Town of Rice Lake, Barron County, Wisconsin, more particularly described as follows:

Commencing at a point at the intersection of the southerly boundary of said Lot 5 and the westerly right of way of 21 $\frac{7}{8}$ th Street also being the point of beginning; thence westerly along the southerly line of said Lot 5 to the easterly ordinary highwater mark of Rice Lake; thence northerly along the said ordinary highwater mark to its intersection with the line dividing the north half and south half of said Lot 6; thence westerly along the said line dividing the north half and south half of Lot 6 to its intersection with the westerly right of way of 21 $\frac{7}{8}$ th Street; thence southerly along said westerly right of way to the point of beginning.

Parcel Number: 038-4375-06-000

Approximately 0.43 acres.

11. Being part of Lots 3 and 4, Rice Lake Summer Resort, located in the Southeast $\frac{1}{4}$ of the Northeast $\frac{1}{4}$ of Section 27, Township 35 North, Range 11 West, Town of Rice Lake, Barron County, Wisconsin, more particularly described as follows:

Commencing at a point of intersection of the southerly line of said Lot 3 and the westerly right of way of 21 $\frac{7}{8}$ th Street; thence westerly along the southerly line of said Lot 3 to

the ordinary highwater mark of Rice Lake; thence northerly along the ordinary highwater mark of Rice Lake to the northerly line of said Lot 4; thence easterly along the northerly line of said Lot 4 to the westerly right of way of 21 7/8th Street; Thence southerly along said westerly right of way to the point of beginning.

Parcel Number: 038-4375-04-000

Approximately 0.49 acres.

12. Being part of Lots 1 and 2, Rice Lake Summer Resort, located in the Southeast ¼ of the Northeast ¼ of Section 27, Township 35 North, Range 11 West, Town of Rice Lake, Barron County, Wisconsin, more particularly described as follows:

Commencing at a point of intersection of the southerly line of said Lot 1 and the westerly right of way of 21 7/8th Street; thence westerly along the southerly line of said Lot 1 to the ordinary highwater mark of Rice Lake; thence northerly along the ordinary highwater mark of Rice Lake to the northerly line of said Lot 2; thence easterly along the northerly line of said Lot 2 to the westerly right of way of 21 7/8th Street; Thence southerly along said westerly right of way to the point of beginning.

Parcel Number: 038-4375-03-000

Approximately 0.48 acres.

13. Being a part of Parcel A, Certified Survey Map No. 248, Volume 3, Page 59; located in the Northeast ¼ of the Northeast ¼ of Section 27, Township 35 North, Range 11 West, Town of Rice Lake, Barron County, Wisconsin, more particularly described as follows:

Commencing at the northeast corner of said Parcel A also being the point of beginning; thence southerly along the easterly boundary of said Parcel A to its intersection with a line 10 feet north of and parallel to the south line of said Parcel A; thence westerly along a line 10 feet north of and parallel to the south line of said Parcel A to the ordinary high water mark of Rice Lake; thence northerly along said ordinary high water mark to the north line of said Parcel A; thence easterly along the northerly line of said Parcel A to the point of beginning.

Parcel Numbers: 276-5006-10-000 & 038-270005-000

Approximately 0.97 acres.

14. Being part of Outlot 230, Rice Lake Assessor's Plat, and part of Parcel A, Certified Survey Map No. 248, Volume 3, Page 59; all located in the Northeast ¼ of the Northeast ¼ of

Section 27, Township 35 North, Range 11 West, Town of Rice Lake, Barron County, Wisconsin, more particularly described as follows:

Commencing at the intersection of the ordinary high water mark of Rice Lake and the north line of said Outlot 230; thence northerly along the said ordinary high water mark to a point 10 feet north of and measured perpendicular to the north line of said Outlot 230; thence easterly along a line 10 feet north of and parallel to the north line of said Outlot 230 to its intersection with the easterly boundary of said Outlot 230 extended northerly; thence southerly to the northeast corner of said Outlot 230; thence southerly along the easterly boundary of said Outlot 230 a distance of 50 feet; thence westerly along a line parallel to the north line of said Outlot 230 to the ordinary high water mark of Rice Lake; thence northerly along the said ordinary high water mark to the point of beginning.

Parcel Number: 276-5006-08-000

Approximately 0.07 acres.

15. Being part of Outlot 230, Rice Lake Assessor's Plat, located in the Northeast $\frac{1}{4}$ of the Northeast $\frac{1}{4}$ of Section 27, Township 35 North, Range 11 West, Town of Rice Lake, Barron County, Wisconsin, more particularly described as follows:

Commencing at the intersection of the ordinary high water mark of Rice Lake and the south line of said Outlot 230; thence northerly along the said ordinary high water mark to a point 50 feet north of and measured perpendicular to the south line of said Outlot 230; thence easterly along a line parallel to the south line of said Outlot 230 to the easterly boundary of said Outlot 230; thence southerly to the southeast corner of said Outlot 230; thence westerly to the point of beginning.

Parcel Number: 276-5006-07-000

Approximately 0.05 acres.

16. All of Lots 1 and 2, Shudlick Park, located in the Northeast $\frac{1}{4}$ of the Northeast $\frac{1}{4}$ of Section 16, Township 35 North, Range 11 West, Town of Rice Lake, Barron County, Wisconsin.

Parcel Numbers: 276-2238-02-000 & 038-4419-03-000

Approximately 1.28 acres.

17. Outlot 4, City of Rice Lake Outlot Plat, located in the Southeast $\frac{1}{4}$ of the Southeast $\frac{1}{4}$ of Section 16, Township 35 North, Range 11 West, Town of Rice Lake, Barron County, Wisconsin.

Parcel Number: 276-5001-03-000

Approximately 2.36 acres.

18. Being all of Lot 9 Assessor's Plat No. 2 of Lots 61-125 of the Plat of Hiawatha Park (now vacated), located in the Northeast $\frac{1}{4}$ of the Northeast $\frac{1}{4}$, of Section 16, Township 35 North, Range 11 West, Town of Rice Lake, Barron County, Wisconsin.

Parcel Numbers: 276-1111-02-000 & 038-4001-10-000

Approximately 0.349 acres.

EXHIBIT C
MAP

See Attached.

ORDINANCE 24-06 MAP 1 OF 3

PRIOR CITY BOUNDARY

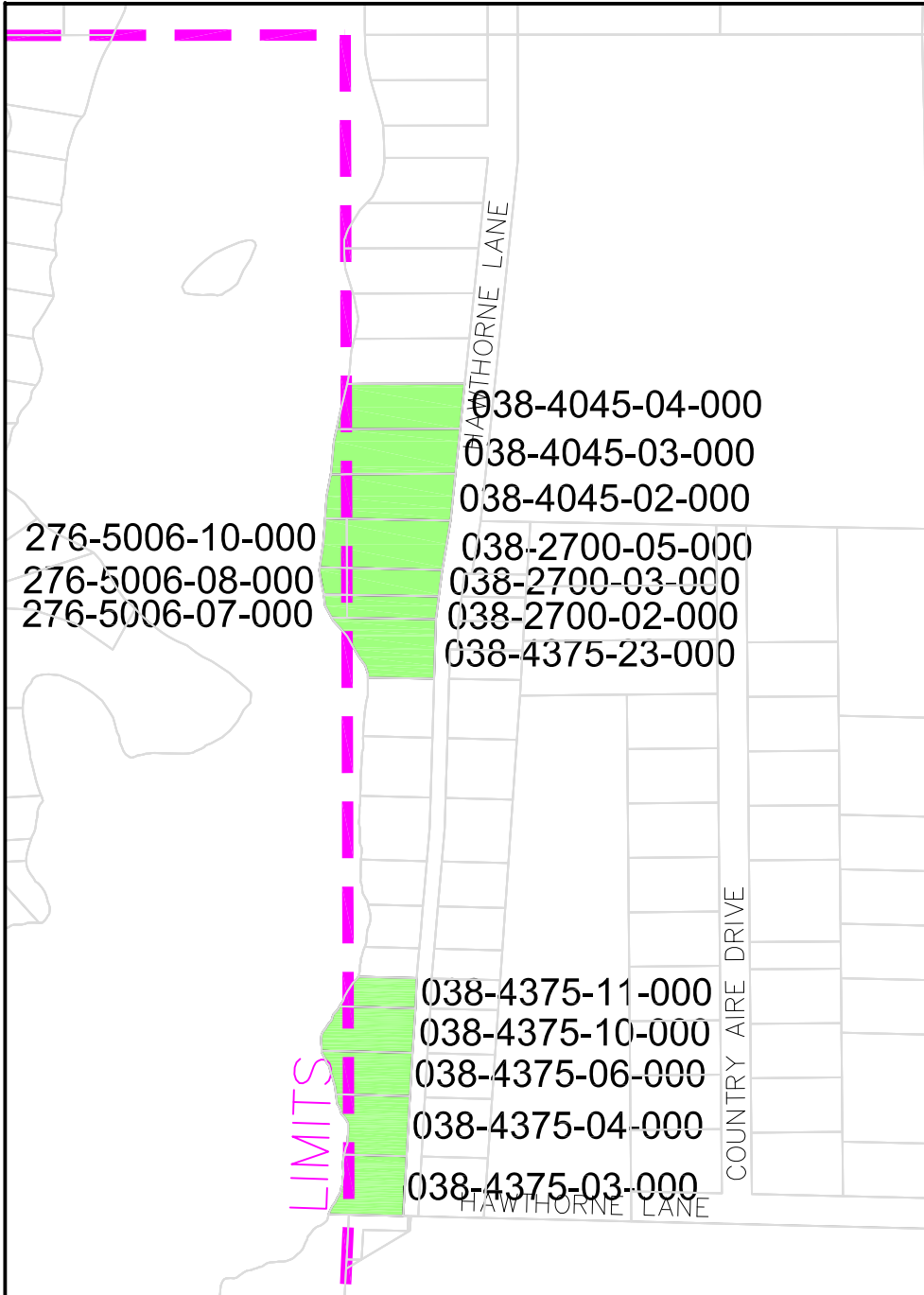

REVISED CITY BOUNDARY

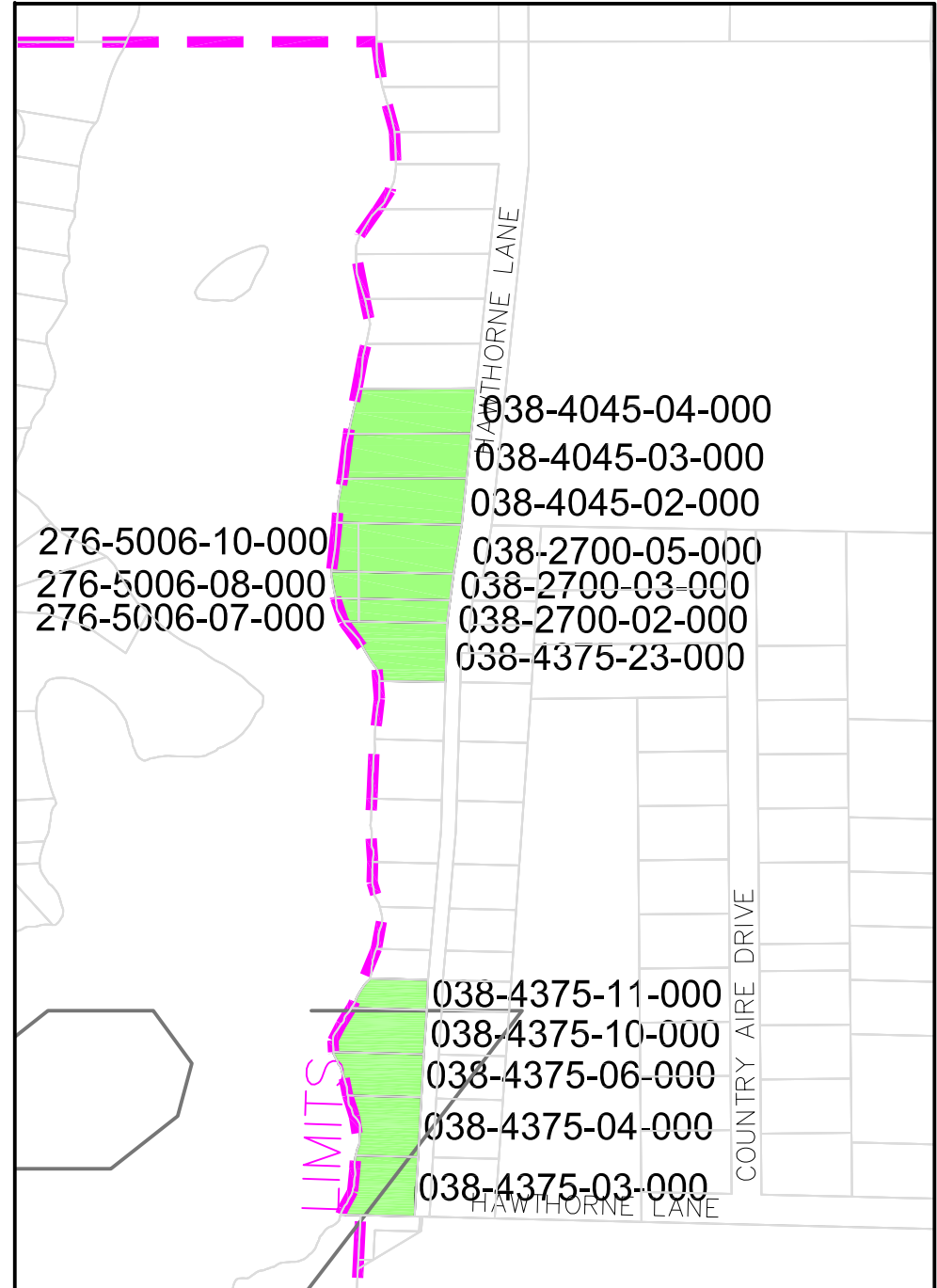

PRIOR CITY BOUNDARY

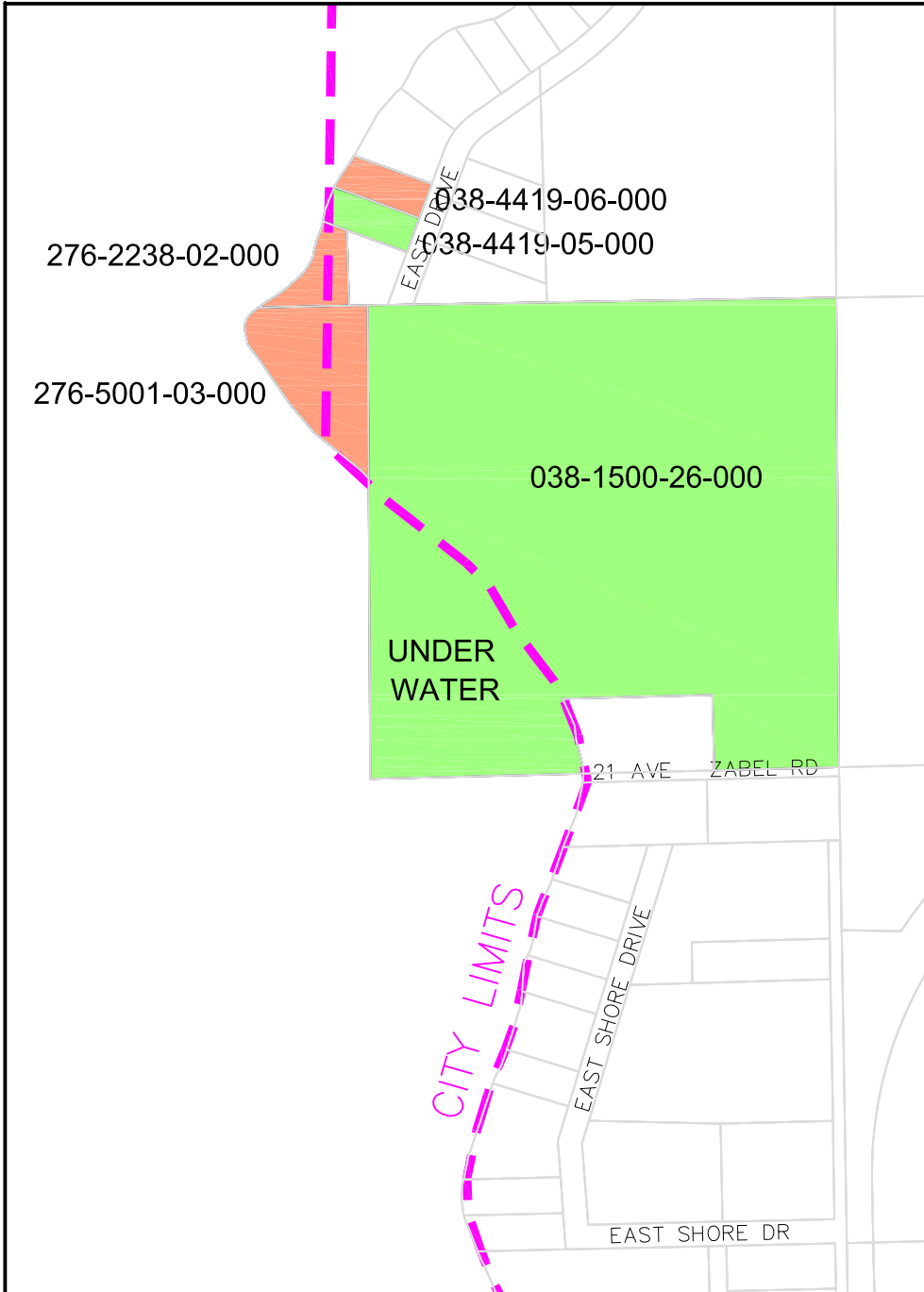

REVISED CITY BOUNDARY

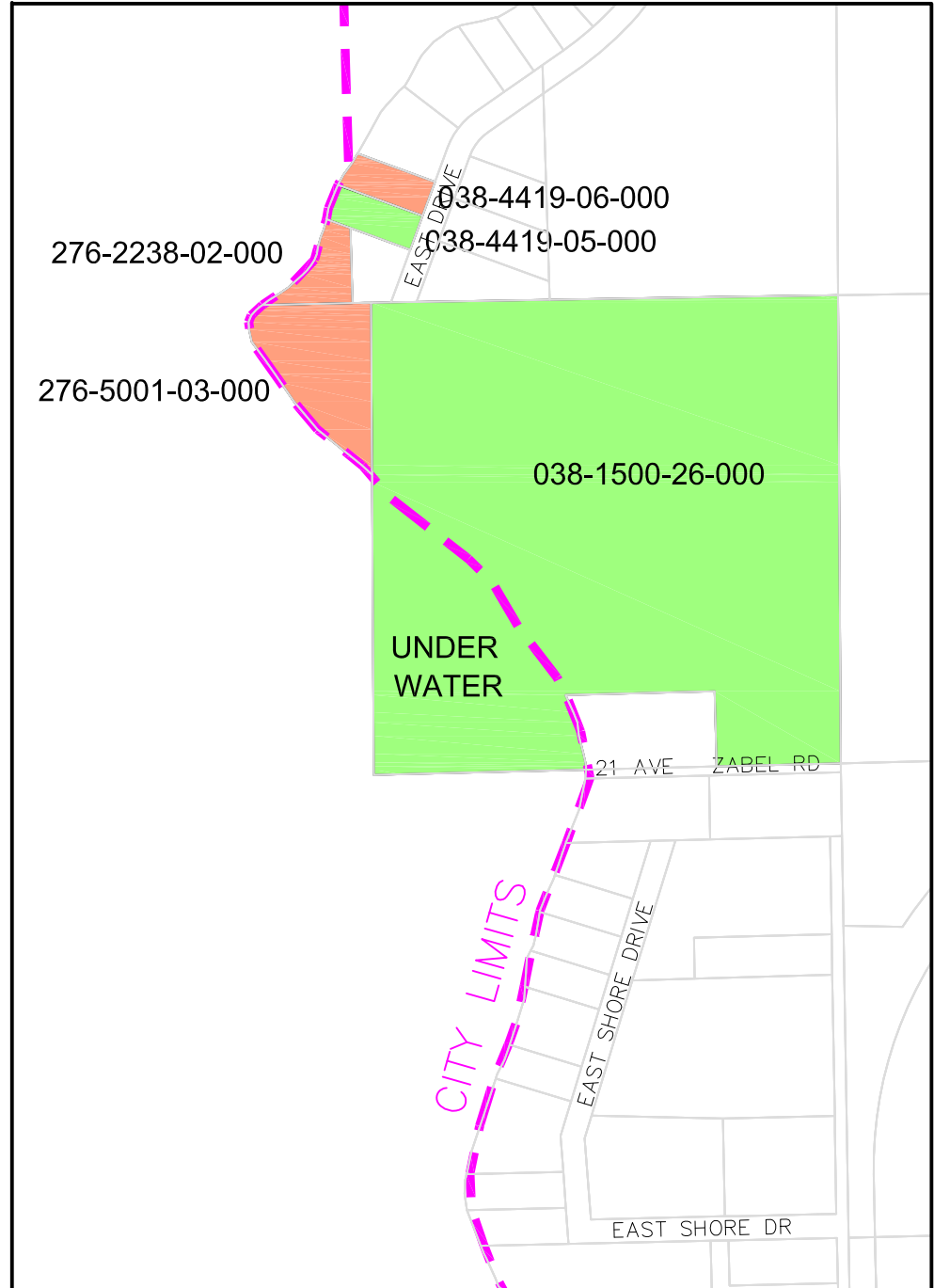

ORDINACE 24-06 MAP 3 OF 3

PRIOR CITY BOUNDARY

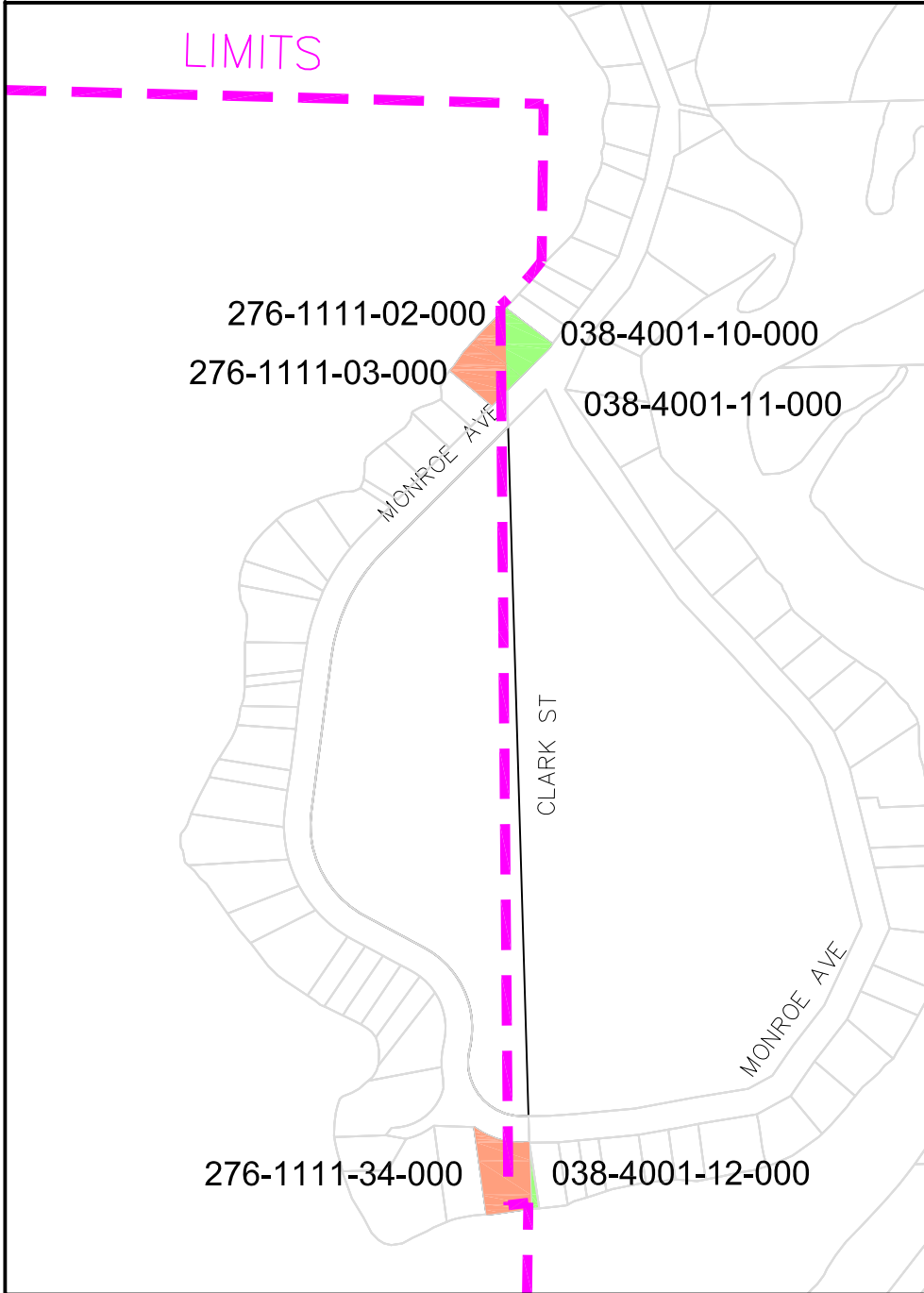

REVISED CITY BOUNDARY

