

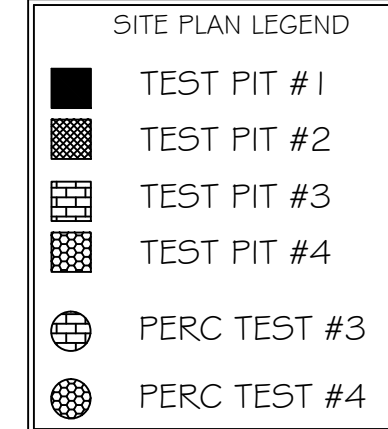

- GENERAL NOTES:
1. SEPTIC TANK TO BE LOCATED A MINIMUM DISTANCE OF 10 FEET FROM THE BUILDING.
 2. ABSORPTION SYSTEM AND RESERVE TO BE LOCATED A MINIMUM DISTANCE OF 20 FEET FROM BUILDING, 10 FEET FROM PROPERTY LINE AND 100 FEET FROM WELL IF UPHILL FROM THE SEPTIC FIELD AND 200 FEET FROM WELL IF DOWNHILL FROM THE SEPTIC FIELD.
 3. NO GARBAGE DISPOSAL SHALL BE USED.
 4. CELLAR DRAINS, ROOF DRAINS OR FOOTING DRAINS SHALL NOT BE DISCHARGED IN THE VICINITY OF THE ABSORPTION SYSTEM.
 5. DRIVEWAYS ARE NOT TO BE CONSTRUCTED OVER ABSORPTION SYSTEM.
 6. NO GRADING OR HEAVY EQUIPMENT WILL BE PERMITTED IN AREA OF THE ABSORPTION FIELD.
 7. NO BASEMENT FIXTURES ARE PERMITTED WITHOUT SPECIAL SEWAGE DESIGN.
 8. ALL TREES AND STUMPS IN ABSORPTION FIELD AREA SHALL BE REMOVED. OTHER VEGETATION (i.e., BRUSH, VINES, WEEDS, GRASS) SHALL BE REMOVED AT GRADE. ALL LEAVES, LIMBS AND BOULDERS ABOVE GRADE SHALL ALSO BE REMOVED.
 9. RAKE SIDES AND BOTTOM OF TRENCH PRIOR TO PLACING GRAVEL IN ABSORPTION TRENCH.
 10. ABSORPTION TRENCH PIPE TO BE CAPPED.
 11. A MINIMUM OF 2 FEET OF SOLID PIPE SHALL BE PROVIDED BETWEEN THE DISTRIBUTION DEVICE AND THE ABSORPTION TRENCHES.
 12. ALL CONSTRUCTION SHALL CONFORM TO THE REQUIREMENTS AS SET FORTH IN THE PUBLICATION "WASTE TREATMENT HANDBOOK INDIVIDUAL HOUSEHOLD SYSTEMS", N.Y.S. DEPT. OF HEALTH FINAL DESIGN MUST BE CERTIFIED BY SUPERVISING ENGINEER PRIOR TO DCHD APPROVAL.
 14. BEFORE STARTING ANY WORK CALL DIG SAFELY NEW YORK @ 1-800-962-7962. WAIT THE REQUIRED TIME, CONFIRM UTILITY RESPONSE, RESPECT THE MARKS AND DIG WITH CARE.
 15. THERE SHALL BE NO BENDS IN THE RAW SEWER LINE.
 16. THE SEPTIC TANK AND THE DISTRIBUTION BOX ARE TO HAVE LOCATION STAKES SO THAT THEY CAN BE ACCESSED, PUMPED, AND INSPECTED ON A REGULAR BASIS.
 17. BENDS NOT TO EXCEED 45 DEGREES ARE PERMITTED IN THE LINE FROM THE SEPTIC TANK TO THE DISTRIBUTION DEVICE, PROVIDED EACH BEND HAS A CLEANOUT.
 18. ALL PIPE PENETRATIONS AND UNUSED INLETS/OUTLETS SHOULD BE SEALED WITH NON-SHRINK GROUT.
 19. OBJECTS AND STRUCTURES SUCH AS SWIMMING POOLS, SHEDS OR DECKS SHALL NOT BE CONSTRUCTED ABOVE SEPTIC TANKS, DISTRIBUTION BOXES, AND ABSORPTION AREAS.
 20. ONSITE WASTEWATER TREATMENT SYSTEMS ARE NOT DESIGNED TO RECEIVE MACERATED WASTEWATER FROM GARBAGE GRINDERS OR INTERNAL SEWAGE PUMP STATIONS.
 21. ONSITE WASTEWATER TREATMENT SYSTEMS ARE NOT DESIGNED TO RECEIVE DISCHARGE FROM WATER SOFTENERS OR FROM OTHER WATER TREATMENT SYSTEMS.
 22. ANY UNAUTHORIZED MODIFICATION OF A DRAWING BEARING THE SEAL OF A LICENSED ENGINEER IS A VIOLATION OF NEW YORK STATE LAW.

AGRICULTURAL DISTRICT NOTE
IT IS THE POLICY OF THE TOWN OF RHINEBECK TO CONSERVE, PROTECT AND ENCOURAGE THE DEVELOPMENT AND IMPROVEMENT OF AGRICULTURAL LAND FOR THE PRODUCTION OF FOOD AND OTHER PRODUCTS AND ALSO FOR ITS NATURAL ECOLOGICAL VAUE. THIS NOTICE IS TO INFORM THE PROSPECTIVE GRANTEE THAT THE PROPERTY HE IS ABOUT TO ACQUIRE LIES PARTIALLY, WHOLLY OR WITHIN FIVE HUNDRED (500) FEET OF EITHER AN AGRICULTURAL DISTRICT OR LAND FOR WHICH AN INDIVIDUAL COMMITMENT HAS BEEN RECEIVED PURSUANT TO S 305 OR 306 OF THE AGRICULTURAL AND MARKETS LAW OF THE STATE OF NEW YORK AND THAT FARMING ACTIVITIES MAY OCCUR ON SUCH PROPERTY, SUCH FARMING ACTIVITIES MAY INCLUDE BUT NOT BE LIMITED TO ACTIVITIES THAT CAUSE NOISE, DUST, ODORS AND OTHER POTENTIAL NUISANCES ASSOCIATED WITH THE AGRICULTURAL OPERATION.



TEST HOLE #1 SOIL PROFILE - 0-62" GRAVELLY LOAM, 62"-84" SILTY LOAM NO MOTTLING, NO BEDROCK, NO GROUNDWATER.
TEST HOLE #2 SOIL PROFILE - 0-65" LOAM, 65"-84" SILTY LOAM NO MOTTLING, NO BEDROCK, NO GROUNDWATER.
TEST HOLE #3 SOIL PROFILE - 0-65" SANDY LOAM, 65"-92" CLAY LOAM NO MOTTLING, NO BEDROCK, NO GROUNDWATER.
TEST HOLE #4 SOIL PROFILE - 0-92" SILTY LOAM WITH BOULDERS NO MOTTLING, NO BEDROCK, NO GROUNDWATER.

STANDARD DUTCHESS COUNTY HEALTH DEPARTMENT NOTES:

THE DESIGN, CONSTRUCTION AND INSTALLATION SHALL BE IN ACCORDANCE WITH THIS PLAN AND GENERALLY ACCEPTED STANDARDS IN EFFECT AT THE TIME OF TCONSTRUCTION WHICH INCLUDE:
"APPENDIX 75-A, WASTE TREATMENT- INDIVIDUAL HOUSEHOLD SYSTEMS, NEW YORK STATE SANITARY CODE."
"NEW YORK STATE DESIGN STANDARDS FOR INTERMEDIATE SIZED WASTEWATER TREATMENT SYSTEMS", NYSDEC
"RESIDENTIAL ONSITE WASTEWATER TREATMENT SYSTEMS, DESIGN HANDBOOK", NEW YORK STATE DEPARTMENT OF HEALTH
"PLANNING THE SUBDIVISION AS PART OF THE TOTAL ENVIRONMENT, NEW YORK STATE DEPARTMENT OF HEALTH."
"NEW YORK STATE DEPARTMENT OF HEALTH AND DUTCHESS COUNTY ENVIRONMENTAL HEALTH SERVICES DIVISION POLICIES, PROCEDURES AND STANDARDS."
"DUTCHESS COUNTY AND NEW YORK STATE SANITARY CODES"
"DUTCHESS COUNTY ENVIRONMENTAL HEALTH SERVICES CERTIFICATE OF APPROVAL LETTER."

THIS PLAN IS APPROVED AS MEETING THE APPROPRIATE AND APPLIED TECHNICAL STANDARDS, GUIDELINES, POLICIES AND PROCEDURES FOR ARRANGEMENT OF SEWAGE DISPOSAL AND TREATMENT AND WATER SUPPLY FACILITIES; AND AS A CONDITION OF THIS APPROVAL, A CONSTRUCTION INSPECTION BY A REPRESENTATIVE OF THE DUTCHESS COUNTY HEALTH DEPARTMENT SHALL BE DONE TO DETERMINE THAT CONSTRUCTION AT THE TIME OF INSPECTION WAS COMPLETED IN GENERAL CONFORMANCE WITH THE APPROVED PLANS AND ANY AMENDMENT THEREOF.

APPROVAL OF ANY PLAN(S) OR AMENDMENT THERETO SHALL BE VALID FOR A PERIOD OF FIVE (5) YEARS FROM THE DATE OF APPROVAL. FOLLOWING THE EXPIRATION OF SAID APPROVAL, THE PLAN(S) SHALL BE RE-SUBMITTED TO THE COMMISSIONER OF HEALTH FOR CONSIDERATION FRO RE-APPROVAL. RE-SUBMISSION OR REVISED SUBMISSION OF PLANS AND/OR ASSOCIATED DOCUMENTS SHALL BE SUBJECT TO COMPLIANCE WITH THE TECHNICAL STANDARDS, GUIDELINES, POLICIES AND PROCEDURES IN EFFECT AT THE TIME OF THE RE-SUBMISSION.

THE DUTCHESS COUNTY DEPARTMENT OF HEALTH SHALL BE CONTACTED PRIOR TO THE COMMENCEMENT OF THE HOME CONSTRUCTION AND/OR ISSUANCE OF A BUILDING PERMIT FOR PRE-CONSTRUCTION INSPECTION TO ENSURE THAT THE ARRANGEMENTS FOR WATER SUPPLY AND SEWAGE DISPOSAL ARE COMMENCED IN ACCORDANCE WITH THE APPROVED PLANS AND AMENDMENTS THERETO AND GENERALLY ACCEPTED STANDARDS.

ALL WELLS AND ONSITE WASTEWATER TREATMENT SYSTEMS, EXISTING OR APPROVED LOCATED WITHIN 300 FEET OF THE PROPOSED WELL AND ONSITE WASTEWATER TREATMENT SYSTEM ARE SHOWN ON THIS PLAN ALONG WITH ANY OTHER ENVIRONMENTAL HAZARDS IN THE AREA THAT MAY AFFECT THE DESIGN AND FUNCTIONAL ABILITY OF THE WELL AND ONSITE WASTEWATER TREATMENT SYSTEM.

ALL PROPOSED WELLS AND SERVICE LINES ON THIS PLAN ARE ACCESSIBLE FOR INSTALLATION AND PLACEMENT.

THE UNDERSIGNED OWNERS OF THE PROPERTY HEREON STATE THAT THEY ARE FAMILIAR WITH THIS MAP, ITS CONTENTS AND ITS LEGENDS AND HEREBY CONSENT TO ALL SAID TERM AND CONDITIONS AS STATED HEREON.

IF THE TANK IS DELIVERED TO THE SITE IN SECTIONS, THEN IT SHALL BE DEMONSTRATED BY THE CONTRACTOR THE THE DC EHSO FIELD INSPECTOR AND/OR DESIGN PROFESSIONAL THAT THE TANK IS SEALED, WATERTIGHT, AND ACCEPTABLE FOR USE. THE TANK MUST ALSO MEET ANY LOCAL TESTING REQUIREMENTS, INCLUDING POSSIBLE ELECTRICAL AND SAFETY STANDARDS.

NO CELLAR, FOOTING, FLOOR, GARAGE, COOLER OR ROOF DRAINS SHALL BE DISCHARGED INTO THE ONSITE WASTEWATER TREATMENT SYSTEM OR WITHIN 50 FEET OF ANY WELL.

ALL BUILDINGS SHALL BE CONSTRUCTED AT AN ELEVATION HIGH ENOUGH TO ENSURE GRAVITY FLOW TO THE ONSITE WASTEWATER TREATMENT SYSTEM.

THERE SHALL BE NO VEHICULAR TRAFFIC OVER THE ONSITE WASTEWATER TREATMENT SYSTEM. PRIOR TO CONSTRUCTION, THE AREA OF THE SYSTEM SHALL BE STAKED OUT AND FENCED OFF.

ONSITE WASTEWATER TREATMENT SYSTEMS SHALL NOT BE INSTALLED IN WET OR FROZEN SOIL.

STORM WATER AND EROSION CONTROL:

ALL REQUIRED EROSION AND SEDIMENT CONTROL AND STORM WATER POLLUTION PREVENTION WATER QUALITY AND QUANTITY CONTROL STRUCTURES, PERMANENT AND TEMPORARY, ARE SHOWN ON THE PLANS.

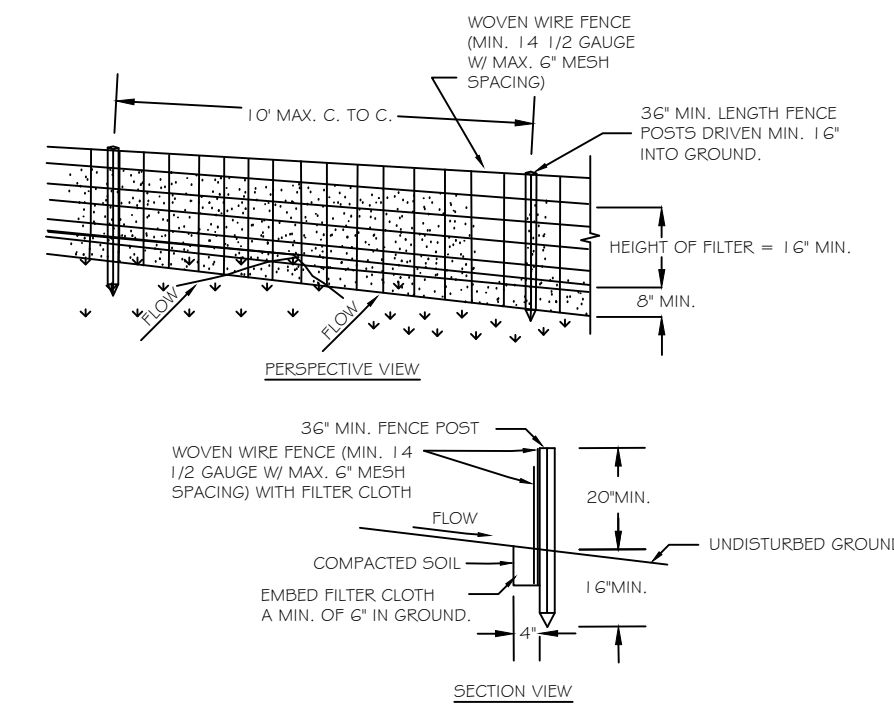

1. WOVEN WIRE FENCE TO BE FASTENED SECURELY TO FENCE POSTS WITH WIRE TIES OR STAPLES. POSTS SHALL BE STEEL EITHER "I" OR "U" TYPE OR HARDWOOD.
2. FILTER CLOTH TO BE TO BE FASTENED SECURELY TO WOVEN WIRE FENCE WITH TIES SPACED EVERY 24" AT TOP AND MID SECTION. FENCE SHALL BE WOVEN WIRE, 1/2" GAUGE, 6" MAXIMUM MESH OPENING.
3. WHEN TWO SECTIONS OF FILTER CLOTH ADJOIN EACH OTHER THEY SHALL BE OVERLAPPED BY SIX INCHES AND FOLDED. FILTER CLOTH SHALL BE EITHER FILTER X, MARIAT 100X, STABILUNA T140X, OR APPROVED EQUIVALENT.
4. PREFABRICATED UNITS SHALL BE GEOTAF, ENVIROFENCE, OR APPROVED EQUIVALENT.
5. MAINTENANCE SHALL BE PERFORMED AS NEEDED AND MATERIAL REMOVED WHEN "BULGES" DEVELOP IN THE SILT FENCE.

SILT FENCE DETAIL NTS

WHILE THIS IS CONSIDERED ONE LOT, THE PORTION IN THE VILLAGE IS ZONED R AND CONTAINS .69 ACRES. THE PORTION IN THE TOWN IS ZONED R10 AND CONTAINS 3.4 ACRES.

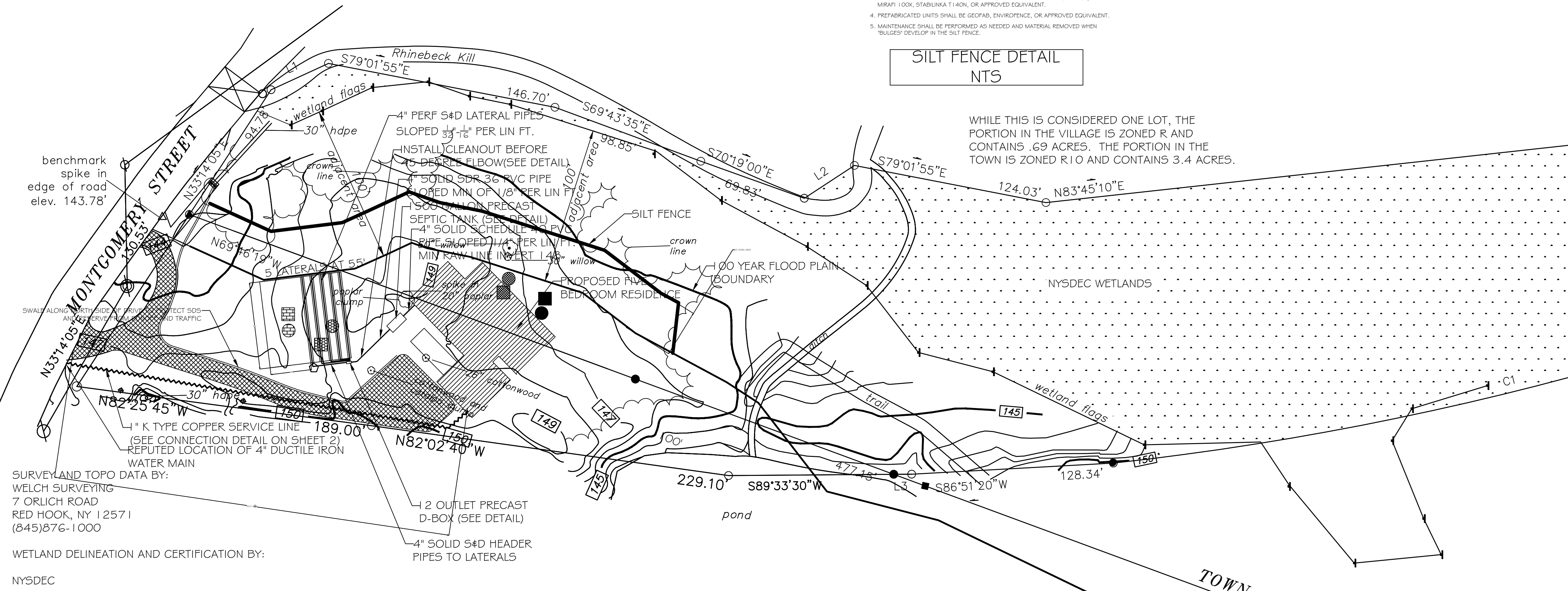

WETLAND DELINEATION AND CERTIFICATION BY:
NYSDEC

DATE _____ OWNER _____

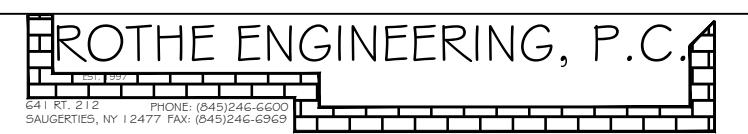

PROPOSED SEWAGE TREATMENT SYSTEM ON LANDS OF STOUT
GRID #89-6170-00-423704-TOWN OF RHINEBECK
GRID #01-G170-10-371687-VILLAGE OF RHINEBECK
DUTCHESS COUNTY

SCALE: 1" = 40'
SHEET 1 OF 2
LAST MODIFIED: 1/21/2020

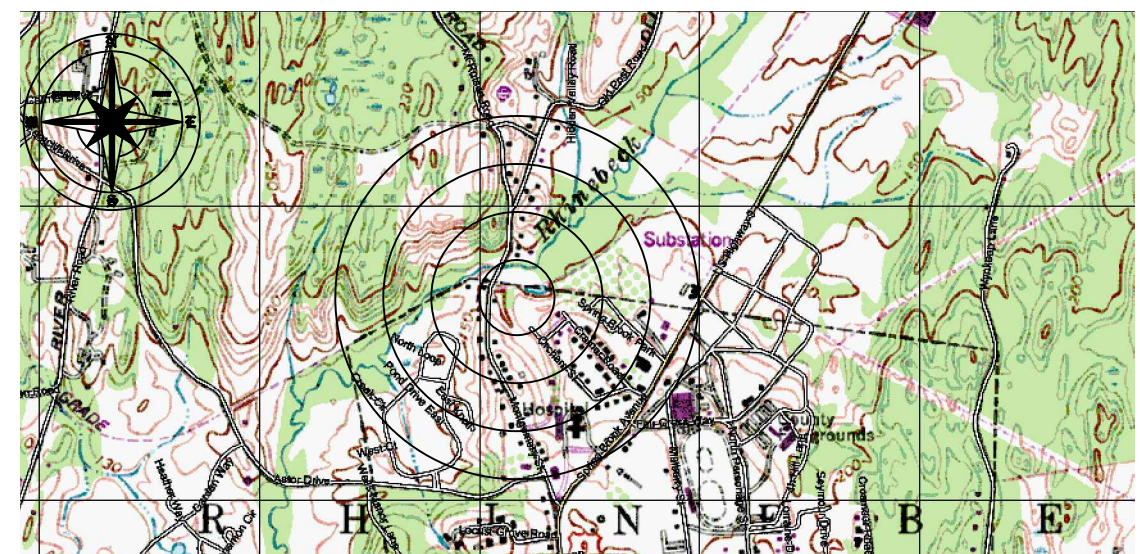
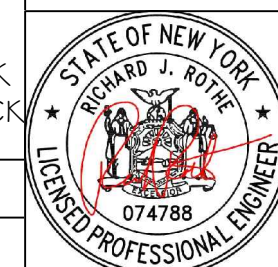

LOCATION MAP



TAX MAP

TOWN OF RHINEBECK APPROVAL
APPROVED BY RESOLUTION OF THE PLANNING BOARD OF THE TOWN OF RHINEBECK, NY ON THE _____ DAY OF _____, 20____, SUBJECT TO ALL REQUIREMENTS AND CONDITIONS OF SAID RESOLUTION. ANY CHANGE, ERRASURE, MODIFICATION OR REVISION OF THIS PLAN AS APPROVED, SHALL VOID THIS APPROVAL.

SIGNED THIS _____ DAY OF _____, 20____
CHAIR _____

OWNERS CERTIFICATION
WE THE UNDERSIGNED OWNER OF THE PROPERTY SHOWN HEREON HEREBY CERTIFY THAT WE ARE FAMILIAR WITH THIS SITE PLAN ITS CONTENTS AND ITS LEGENDS AND HEREBY CONSENT TO ALL SAID TERMS AND CONDITIONS AS STATED HEREON AND HEREBY

DATE _____
DATE _____